



**Hi-BAC**<sup>TM</sup>  
SAFETY SEAT

READ AND SAVE THIS MANUAL

**OWNERS MANUAL**  
INTERNATIONAL

# PRODUCT DESCRIPTION

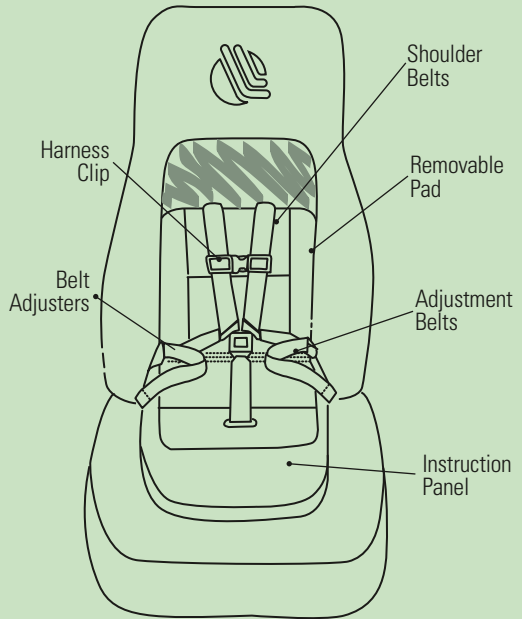
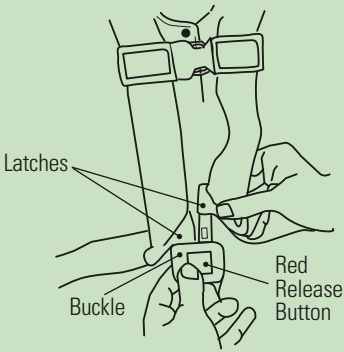

## CUSTOMER SERVICE

We're committed to customer service and satisfaction. Should replacement parts, service or assistance be needed while operating or caring for this product, call the EEC representative, EVS Europe Ltd. at **01376 552399** or EVS Ltd. can be reached in the USA at

001 (574) 233-5707. The **Model Number, Date of Manufacture and Serial number are located behind the removable child seat pad** on the seat back shell and on the label below. Please have this information available when you call.

# PRODUCT CLEANING & DISINFECTING

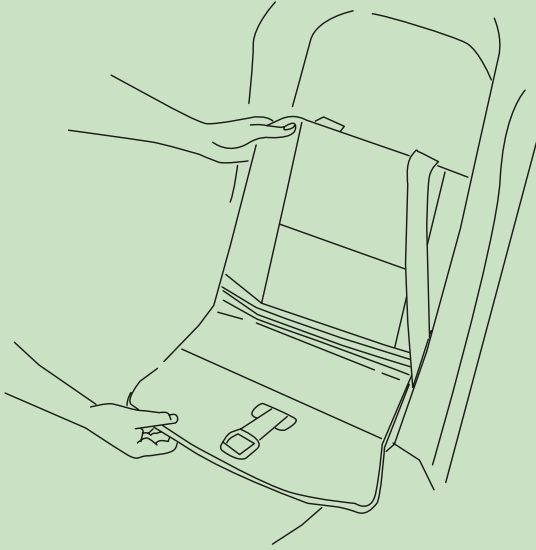

Clean the Hi-BAC Safety Seat with household or industrial grade detergent. Always follow the manufacturer's instructions. Cleaning with abrasive materials is not recommended. The harness belts can be scrubbed with a nylon brush. The child restraint seat pad can be removed for cleaning by gently lifting it from the Velcro® fasteners.

To disinfect: Use Chlorine bleach, Isopropyl Alcohol or a 3% Hydrogen Peroxide solution.

When using disinfectants, always follow the manufacturer's instructions. Some disinfectants can be harmful.

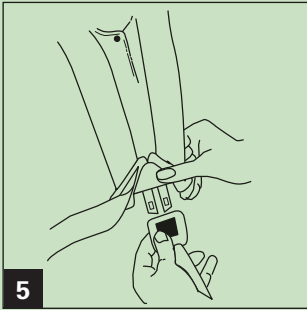

**5** Set the child upright in the child seat. Place a shoulder belt over each shoulder. While holding the buckle, overlap both latch plates together and insert simultaneously into the buckle. Tug firmly to be sure latch is secure.

**CAUTION!!** Be certain that the belts are not twisted and that the harness buckle is free of foreign matter which could cause it not to latch properly.



**6** Pull the adjustment belts until the shoulder belts are snug while maintaining the lap straps as low as possible over the pelvis.

**CAUTION!!** Heavy clothing or blankets can interfere with proper adjustments. Check carefully.

## **TO RELEASE THE CHILD**



**7** Press the red release button on the buckle to unbuckle both latches simultaneously and slide belts off the child's shoulders. Gently remove the child.

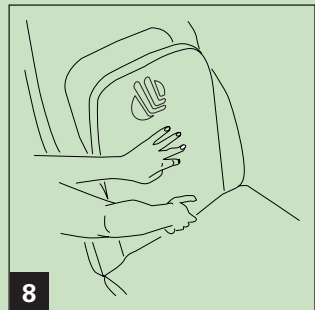

**8** Press the red release button on the buckle to unbuckle both latches simultaneously and slide belts off the child's shoulders. Gently remove the child.

# USING THE Hi-BAC™ SAFETY SEAT

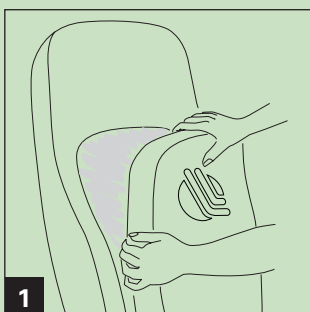

Gently pull the seat-back cushion forward to expose the child seat.

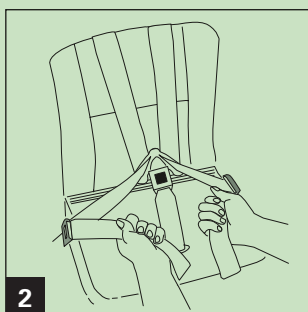

Before the child is seated, tug firmly on each adjustment belt to remove any slack in the harness system.

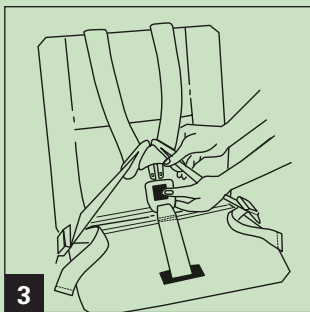

Press the red release button on the buckle to eject both latches simultaneously.

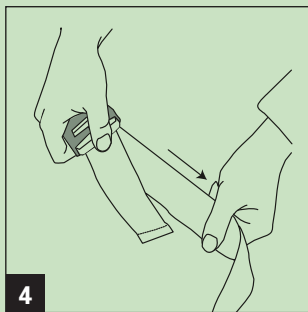

Depress the light grey release mechanism on both belt adjusters to completely extend the harness belts.

# WARNINGS!!!

## FAILURE TO FOLLOW THE MANUFACTURER'S INSTRUCTIONS ON THE USE OF THE CHILD RESTRAINT SYSTEM CAN RESULT IN INJURY TO THE CHILD DURING A SUDDEN STOP OR CRASH. SNUGLY ADJUST THE BELTS PROVIDED WITH THE CHILD RESTRAINT AROUND THE CHILD.

- Children **MUST** be **1 year old, between 9 kg to 25 kg, 71 cm to 120 cm tall**, and capable of sitting upright alone.

- The Hi-BAC Safety Seat should **NOT** be used in situations where injuries to the child preclude its use.

- The Hi-BAC™ Safety Seat is **NOT** designed to be used for spinal immobilization. Use only as described in this manual.

- The Hi-BAC™ Safety Seat should **NOT** be used in an area where it may come in contact with a Supplemental Restraint System (SRS)/airbag.

- The rear-facing Hi-BAC™ Safety Seat when mounted on an E.V.S. Ltd. cabinet or swivel base (EVS 185S) **MUST** be positioned either all the way forward **away** from the bulkhead, or if possible, snugly **against**



the bulkhead when transporting children.

- **NEVER** leave a child unattended. An unattended child can be injured.

- The Hi-BAC™ Safety Seat should **NOT** be used if it has been altered or damaged in any way, such as

involvement in an accident. Report incident to EVS Europe Ltd. immediately at **01376 552399**.

- It is required that medical instruments, test equipment, or any objects not in use be stowed away or secured in some manner.

- It is required that the child seat never be used without the E.V.S. Ltd. installed child seat pad in place, nor should the child seat pad be replaced with any other non-factory pad. This child pad is a specifically engineered component of the system.

**READ AND SAVE THIS MANUAL.**

# INTENDED USE & SAFETY INFORMATION

**Growing concern for child safety has lead many countries to pass legislation making it mandatory for emergency medical providers to have available a child restraint system that satisfies the standards enacted in the country for intended use. In most countries the child seat must be available in the emergency vehicle at all times.**

**The Hi-BAC™ Safety Seat is “two seats in one” incorporating a built-in child seat and an ergonomically-correct attendant seat specifically designed for installation in ambulances and rescue vehicles assuring the convenient and safe transportation of uninjured children as well as the attendant.**

This seat has been designed and tested for **rear and forward facing use only** by children in **Group I** and **Group II ranging in mass of 9 kg to 25 kg** as specified in E.C.E. R44.3 “Child Restraint Systems”. E.V.S. also recommends that the **child range in height from 71cm to 120 cm.** and capable of sitting upright and along. Children LESS than 1 year old, or those under the weight, height or capability requirements must use an infant seat. The Hi-BAC™ Safety Seat is not intended for infant use.

Children that exceed the weight and height requirements should not use the child restraint. Instead, stow away the child restraint and use the Hi-BAC™ Safety Seat with the vehicle’s safety belt system.

The Hi-BAC™ Safety Seat meets or exceeds all applicable ECE R44.3 “Child Restraint Systems” for its intended use which are in effect at the date of manufacture.

To assure the safety of those persons being transported in the Hi-BAC™ Safety Seat the individual AMBULANCE trust should develop a policy for the proper use and maintenance of this product.

If you are in need of help on the proper operation or care of this product **call EVS Europe Ltd. 01376 552399** for assistance or e-mail **evssales@evsltd.com**. Please have the product identification numbers available. They are located at the bottom page 7 of this Owner’s Manual.

# LIMITED WARRANTY

EVS, Ltd. warrants its products to be free of defects in materials and workmanship for one (1) year from the date of shipment. The warranty obligation is limited to the repair or replacement of defective parts or a refund of the purchase price at the option of EVS, Ltd. Damage, indirect or consequential, or as a result

of abuse, neglect, carelessness, or misuse is not covered under this warranty obligation. This is only a summary. Actual terms, conditions and disclaimers are available upon request. The complete warranty policy can be seen at [www.evsltd.com](http://www.evsltd.com). or contact EVS Europe Ltd. **01376 552399** to obtain a copy.



## **NORTH AMERICA**

3702 West Sample Street  
South Bend, Indiana 46619  
Local and International: 574.233.5707  
OEM and Aftermarket: 800.364.3218  
Fax: 574.288.9363 E-mail: [evssales@evsltd.com](mailto:evssales@evsltd.com)  
Web: [www.evsltd.com](http://www.evsltd.com)

## **EVS EUROPE LTD.**

Unit 1, Chilford Court, Rayne Road  
Braintree, Essex CM7 2QS, England  
Tel: 44 (0) 1376 552399  
Fax: 44 (0) 1376 552411  
Email: [enquiries@evseurope.com](mailto:enquiries@evseurope.com)  
Web: [www.evsltd.com](http://www.evsltd.com)